

**TORO.** Count on it.

## Groundsmaster® 7200/7210



**TORO.** Count on it.

# A Groundsmaster from A to Z.

## Groundsmaster<sup>®</sup> 7200/7210

- 28 hp (21 kW) or 35 hp (26 kW) Kubota<sup>®</sup> diesel engine
- 7-gauge welded steel cutting decks
- Integrated direct-drive transmission
- Hydraulic deck lift
- Quick Attach System<sup>™</sup> (QAS) – no tools required
- Polar Trac<sup>™</sup> System – mow-to-snow versatility

Introducing the new zero-radius turn rotary mowers rugged enough to be called Groundsmasters. These new machines have powerful Kubota<sup>®</sup> 28 hp (21 kW) or 35 hp (26 kW) 3-cylinder liquid-cooled diesel engines to get the job done. Heavy-duty 7-gauge welded deck construction, the industry's toughest spindle assembly, and shaft-driven cutting decks make these Groundsmasters hard to beat.



## Count on Versatility

### Polar Trac System

Convert the Groundsmaster 7200/7210 from mowing into a powerful snow removal machine in less than 4 hours. The patent-pending Polar Trac System is ready for all winter conditions with its heated hard cab, innovative rubber track system, and quick-connect attachments.





## More Versatile.

Use one machine to maintain your softball or baseball complex. The Groundsmaster 7200/7210 can both mow the outfield and groom the dirt infield. With the exclusive QAS (Quick Attach System) you can switch between attachments in less than a minute without tools. Sports field grooming attachments include: a debris blower, finish grader, tooth rake, drag mat, and Rahn® groomer. When winter strikes you'll be ready with the patent-pending Polar Trac System. Quick-connect Polar Trac attachments include: snowthrower, rotary broom, angled snow blade, and V-plow.

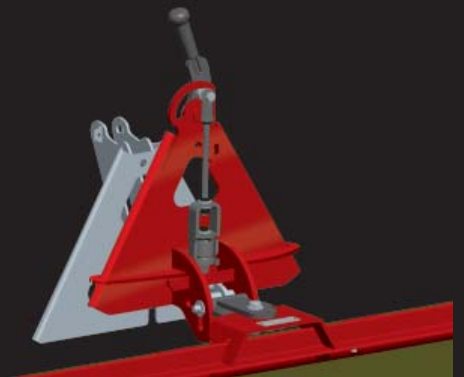

The exclusive Toro QAS makes attachment changes easier than ever.

# Built to be a Groundsmaster.®

The Groundsmaster 7200/7210 cutting decks stand up to the rigors of everyday use with high-strength, 7-gauge welded-steel construction that resists cracking. In fact, Toro decks are 33% thicker and 85% stronger than competitive decks made from ordinary 10-gauge steel. The decks also employ heavy-duty spindle assemblies with a 9" (23 cm) diameter base to absorb impacts that would damage most other assemblies.

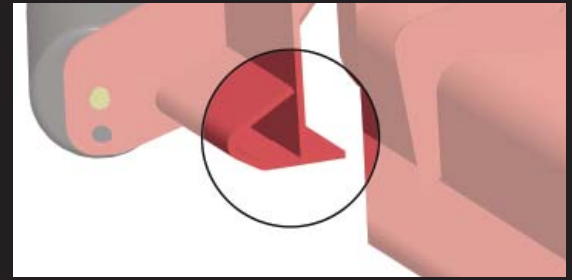

**Bull-nose Bumper** – This unique design provides durability and minimizes blowout of grass and dust. The leading edge is raised ¼" (64 mm) so grass stands up straight for a cleaner cut.

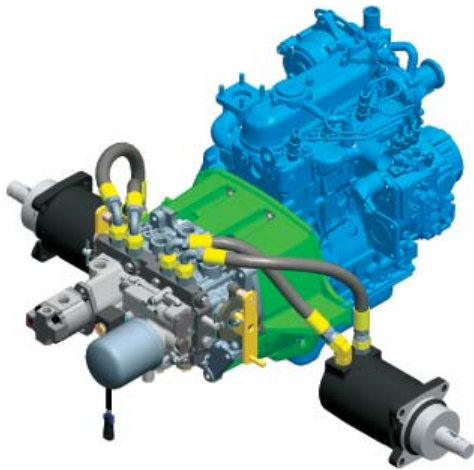

**Transmission** – The direct-drive transmission integrates wheel motor pumps, a hydraulic wet disc clutch and engine power linkage. Coupling the transmission directly to the engine eliminates drive belts and creates an efficient and robust powertrain system that requires less maintenance and service.

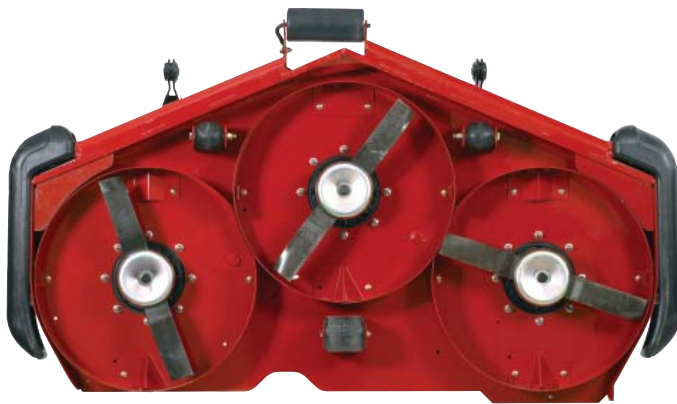

**62" (158 cm) & 72" (183 cm) Guardian® Recycler® Deck** – The patented vertical discharge system offers improved safety and clipping management by forcing the clippings to be cut and re-cut.

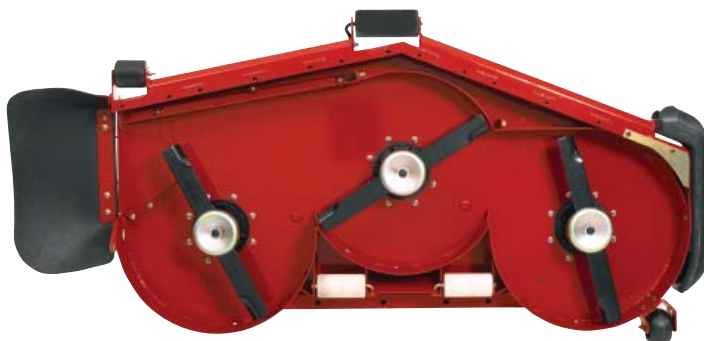

**72" (183 cm) Side Discharge Deck** – A blade tip speed of 18,000 fpm assures a cleaner cut without sacrificing mowing speed. The patent-pending rubber discharge deflector disperses clippings evenly while protecting trees and other objects from damage.

# Attachments

Jack Stand



Debris Blower



Sunshade



## Also Available:

- Striping Kit
- Road Light Kit
- Leaf Mulching Kits
- Atomic Blades
- 12V Power Port
- Lug Tire

## Infield Grooming:

- Tooth Rake
- Coco Drag Mat
- Finish Grader
- Steel Drag Mat

## Polar Trac Attachments:

- V-Plow
- Rotary Broom
- Snowthrower
- Angled Snow Blade



The standard ROPS not only provides rollover protection, it also folds down for storage and trailer transport.

## All-day comfort.

The Groundsmaster 7200/7210 is the ideal choice for productivity and operator comfort. It is capable of a 12.5 mph (20.9 km/hr) mow/transport speed and the 11.5-gallon (43.5 liter) fuel tank is large enough for a

full day of mowing. The hydraulic deck lift, zero-turn stick operation, deluxe suspension seat and cup holder ensure operator comfort and reduce fatigue.

# Specifications for Groundsmaster® 7200/7210

## Engine

**Model:** Kubota®, 3-cylinder, diesel  
**Rating:** 7200: 28 bhp (21 kW)  
7210: 35 bhp (26 kW) turbo  
**Displacement:** 1123 cu. in. (18.4 liter)  
**Fuel:** Diesel  
**Fuel capacity:** 11.5 gallon (43.5 liter)  
**Cooling:** Liquid

## Traction Unit

**Transmission:** Direct drive to engine, integrates dual wheel motor pumps and hydraulic clutch directly mounted to engine  
**PTO Clutch:** Hydraulically actuated wet multi-disc clutch  
**Wheel Drive:** Independent high-torque, low-speed wheel motors with 310cc displacement  
**Steering:** Adjustable twin sticks with high performance CYB® hydraulic dampers  
**Deck Lift:** Hydraulic  
**Instrumentation:** Hour meter, glow plug, temperature, oil pressure, alternator  
**Seat:** High back cushion, adjustable for operator weight, seat back angle, fore/aft position, lumbar support and armrest height  
**ROPS:** 2-post foldable

## Electrical

**Battery:** 12 volt, 540 CCA  
**Alternator:** 40 amp  
**Interlock:** Traction neutral, operator presence, parking brake, PTO on, auxiliary hydraulics on, high temp and overtemp

## Tires

**Drive:** 24 x 12-12, 6-ply pneumatic tubeless, demountable and interchangeable  
**Front castor:** 15 x 6-6, tubeless, 4-ply ribbed

## Dimensions

**Length:** 95" (241.3 cm)  
**Height:** 72" w/ROPS up (190 cm), 48" w/ROPS down (122 cm)  
**Wheelbase:** 57" (145.8 cm)  
**Width:** 75" (191 cm) w/72" Side Discharge; 78" (198 cm) w/72" Guardian Recycler; 68" (173 cm) w/62" Guardian Recycler  
**Weight:** 1900 lbs. (862 kg)

## Ground Speed

0-12.5 mph (0-20.1 km/h) forward; 0-8.5 mph (0-13.7 km/h) reverse

## Cutting Units

62" (158 cm) Guardian® Recycler® Deck  
**Type:** 3-blade  
**Width of cut:** 62" (156 cm)  
**Height of cut:** 1-6" (3-15 cm), adjustable in 1/4" (6.35 mm) increments  
**Mowing Rate:** 3.1 acres/h (1.3 hectares/h) at 5 mph (8 km/h)  
**Construction:** 7-gauge welded steel

72" (183 cm) Guardian Recycler Deck  
**Type:** 3-blade, front mounted rotary  
**Width of cut:** 72" (183 cm)  
**Height of cut:** 1-6" (3-15 cm), adjustable in 1/4" (6.35 mm) increments  
**Mowing Rate:** 3.6 acres/h (1.5 hectares/h) at 5 mph (8 km/h)  
**Construction:** 7-gauge welded steel

72" (183 cm) Side Discharge  
**Type:** 3-blade, front mounted rotary  
**Width of cut:** 72" (183 cm)  
**Height of cut:** 1-6" (3-15 cm), adjustable in 1/4" (6.35 mm) increments  
**Mowing Rate:** 3.6 acres/h (1.5 hectares/h) at 5 mph (8 km/h)  
**Construction:** 7-gauge welded steel  
**Chute:** 5/16" (8 mm) rubber discharge

**Warranty:** Two-year limited

## TORO® PROFESSIONAL SERVICES

**Toro Financing** A full service offering for all your equipment and irrigation purchases. Flexible financing options can be tailored to meet your operational needs.

**Toro Protection Plus Extended Protection Plan** Protect your budget and your equipment investment. Plans are available for both new and used equipment, and you can choose from various terms to fit your financing terms.

**Toro Genuine Parts** Keep the productivity and performance of your equipment at its peak. Learn about Performance Parts pricing and MVP kits. Find replacement parts online at [Toro.com/partsviewer](http://Toro.com/partsviewer).

**Toro Training** Toro Factory Service Schools are available. Explore the training and customer care areas of [Toro.com](http://Toro.com) and [ToroNSN.com](http://ToroNSN.com) for readily available education and training materials.

**Toro Controller Repair** Provides irrigation controller boards ready for immediate board exchange to assure that downtime is minimal and your turf stays protected. Toro is the choice for reliability.

**Toro NSN®** An industry-first support network that provides reliable, around-the-clock irrigation central control system troubleshooting and operation assistance. Call 1-800-ASK-TORO.

**NEW! myTurf™ Fleet Management** This free online tool from Toro keeps track of maintenance for all of your turf equipment. Complete product information and parts ordering is also included.

Products depicted in this brochure are for demonstration purposes only.  
Actual products offered for sale may vary.  
©2006 The Toro Company, 8111 Lyndale Ave. S., Bloomington, MN 55420-1196  
Part No. 06-041-T. Printed in U.S.A.

[Toro.com](http://Toro.com)



**Count on it.**